



**BUSINESS AND PLANNING ACT 2020**  
**PAVEMENT LICENCE**  
**23/14581/LIPAVE**

Crawley Borough Council being the Licensing Authority of the above Act, **HEREBY GRANTS A PAVEMENT LICENCE** to:

Octopus Bar

To trade at:

Octopus Bar  
George Hotel  
56 - 58 High Street  
West Green  
Crawley  
West Sussex  
RH10 1BS

The size/specification of the trading area is:

12m x 10.5m





16. All potential obstructions must be removed from the Public Highway when the premises are

31. The Licence Holder is required to display the attached Licence in a prominent position in a front window, or door, of the premises so that it is visible to any person.

32.

**ANNEX 2**

**PLAN OF TRADING AREA**

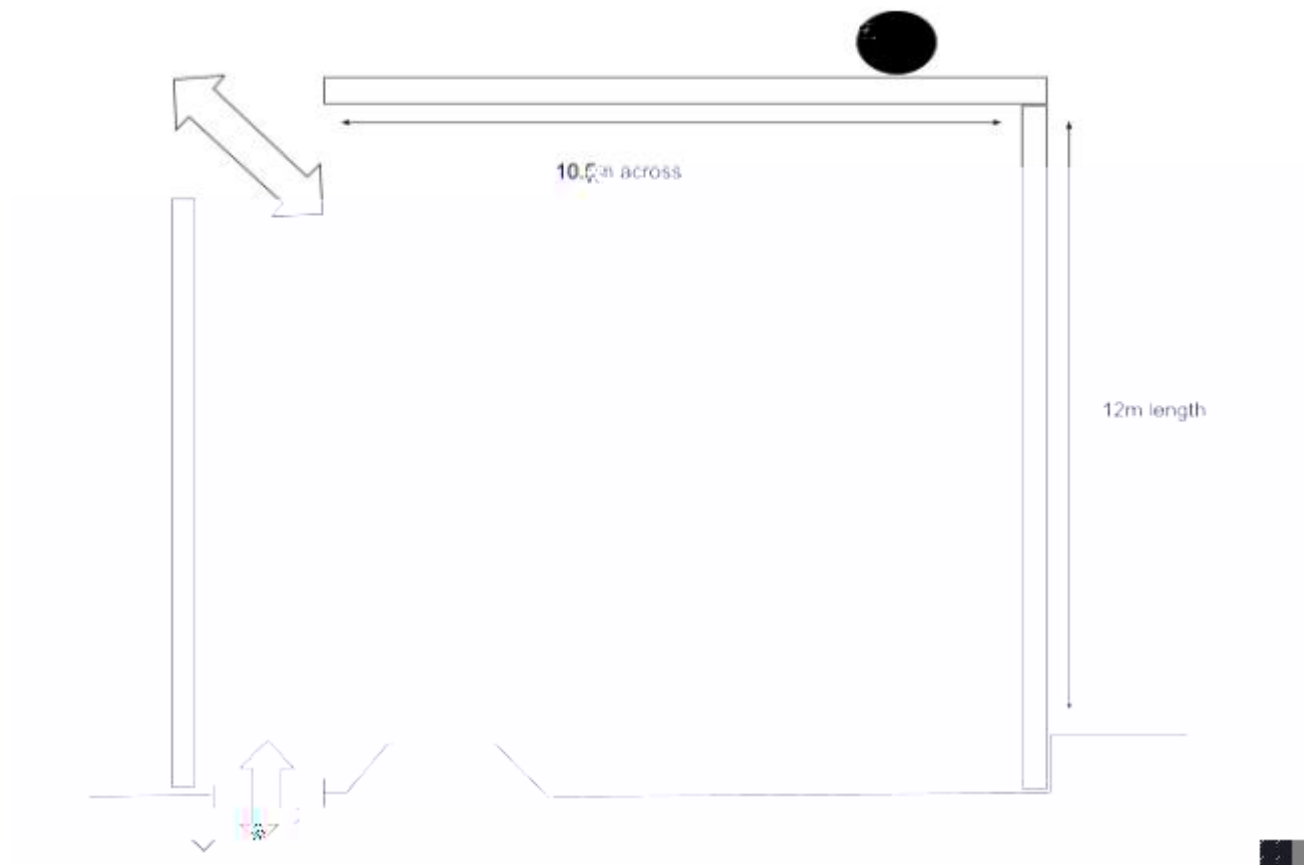

# Crawley Borough Council Pavement Licence Conditions

1. The grant of this pavement licence does not grant the licence-holder an exclusive right to use the Licence Site. The licence-holder must give Crawley Borough Council and other public authorities including the Police, Highways Authority, and other Statutory Undertakers) access to the Licence Site for emergencies, maintenance, installation, special events, improvements, or any other reasonable cause. If the consequence of access is that the licence

- iii. having normal access to premises adjoining the relevant highway,
  - b. preventing any use of vehicles which is permitted by a pedestrian planning order, or which is not prohibited by a traffic order,
  - c. preventing statutory undertakers having access to any apparatus of theirs under, in, on or over the highway, or
  - d. preventing the operator of an electronic communications code network having access to any electronic communications apparatus kept installed for the purposes of that network under, in, on or over the highway.
8. Where the furniture to be put on the relevant highway consists of seating for use by persons for the purpose of consuming food or drink, the licence-holder must make reasonable provision for seating where smoking is not permitted.
  9. The method of marking the boundary of the licensed area must be agreed between the licence holder and Officers of Crawley Borough Council. Whatever method is agreed a 2-metre clear walkway must be maintained for the use of pedestrians.
  10. Emergency routes to the premises and adjacent buildings must not be obstructed by the Pavement Licence, which should not, in normal circumstances, extend beyond the width of the premises frontage.
  11. The only furniture which may be placed on the Licence Site pursuant to this licence is that which was described as part of the application or subsequently approved by an officer of Crawley Borough Council.
  12. The licence-holder must keep any furniture placed on the Licence Site pursuant to this licence in a good state of repair.
  13. Crawley Borough Council will have no liability for any damages in the event of any of the furniture permitted to be placed on the Licence Site by this Licence is lost, stolen or damaged in any way from whatsoever cause.
  14. Furniture should be placed so as not to obstruct driver sightlines, or road traffic signs.
  15. Placement of furniture permitted to be placed on the Licence Site must allow pedestrians to use the footway parallel to the frontage of



19. During the hours of darkness suitable and sufficient lighting must be provided to ensure safe use of the area.
20. All detritus (food and drink remnants, spillages, bottles, cans, wrappers etc) be regularly removed from the Licence Site. The licence holder must make arrangements to regularly check for and to remove litter and rubbish on pedestrian walkways, caused by persons using the premises, for a distance of up to 10 metres from the boundary of the Licence Site.
21. The licence holder must ensure that any tables placed on the Licence Site pursuant to this licence are cleared in an efficient manner during the hours of operation. The licence holder must ensure the licensed area and surrounding highway is to be washed down at the completion of each day's usage using a method sufficient to remove food debris, grease and other spillages that may occur.
22. All furniture covered by the Licence shall be freestanding. The licence holder is not permitted to

Dated 31<sup>st</sup> day of August 2023



Signed

Head of Community Services

, KHUHE\ DFNQRZOHGJH UHFHLSW RI WKH &RXQW\ &RXQFLOV SH  
accept the conditions contained therein.

6 L J Q H G « « « « « « « « « « « « « « « «  
On behalf of

Dated: